

**DANCO**<sup>®</sup>  
MADE IN ITALY

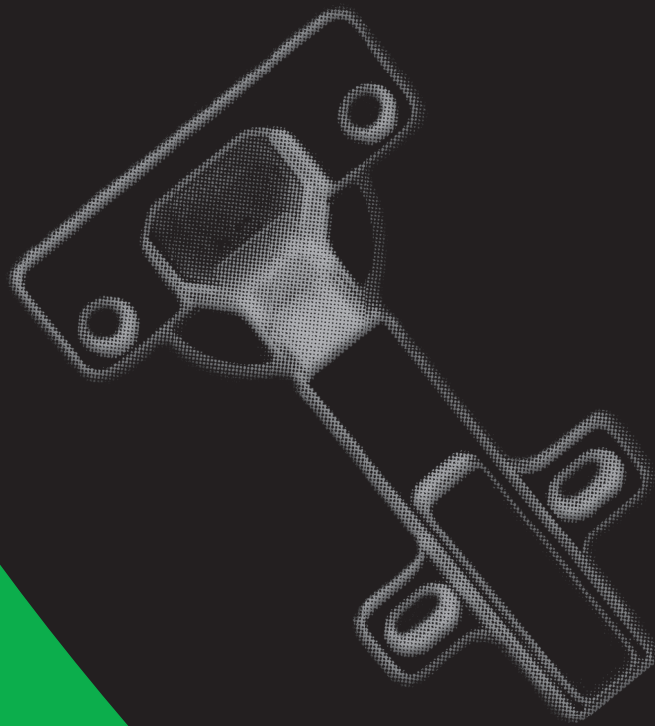

**7**

SERIE 640

**dal 1956**  
**i nostri prodotti**  
**hanno un'anima**  
**tutta italiana.**



**since 1956**  
**our products**  
**have a spirit**  
**all italian.**



## Indice Index

SERIE 640  
640 SERIE

pag. 06  
page 06



CASSE  
CUPS

pag. 12  
page 12



BASETTE  
MOUNTING PLATES

pag. 14  
page 14



ACCESSORI  
ACCESSORIES

pag. 18  
page 18



ESEMPIO D'ORDINE  
EXAMPLE OF ORDER

pag. 20  
page 20



## NUMERO DI CERNIERE PER PORTA NUMBER OF HINGES FOR DOOR

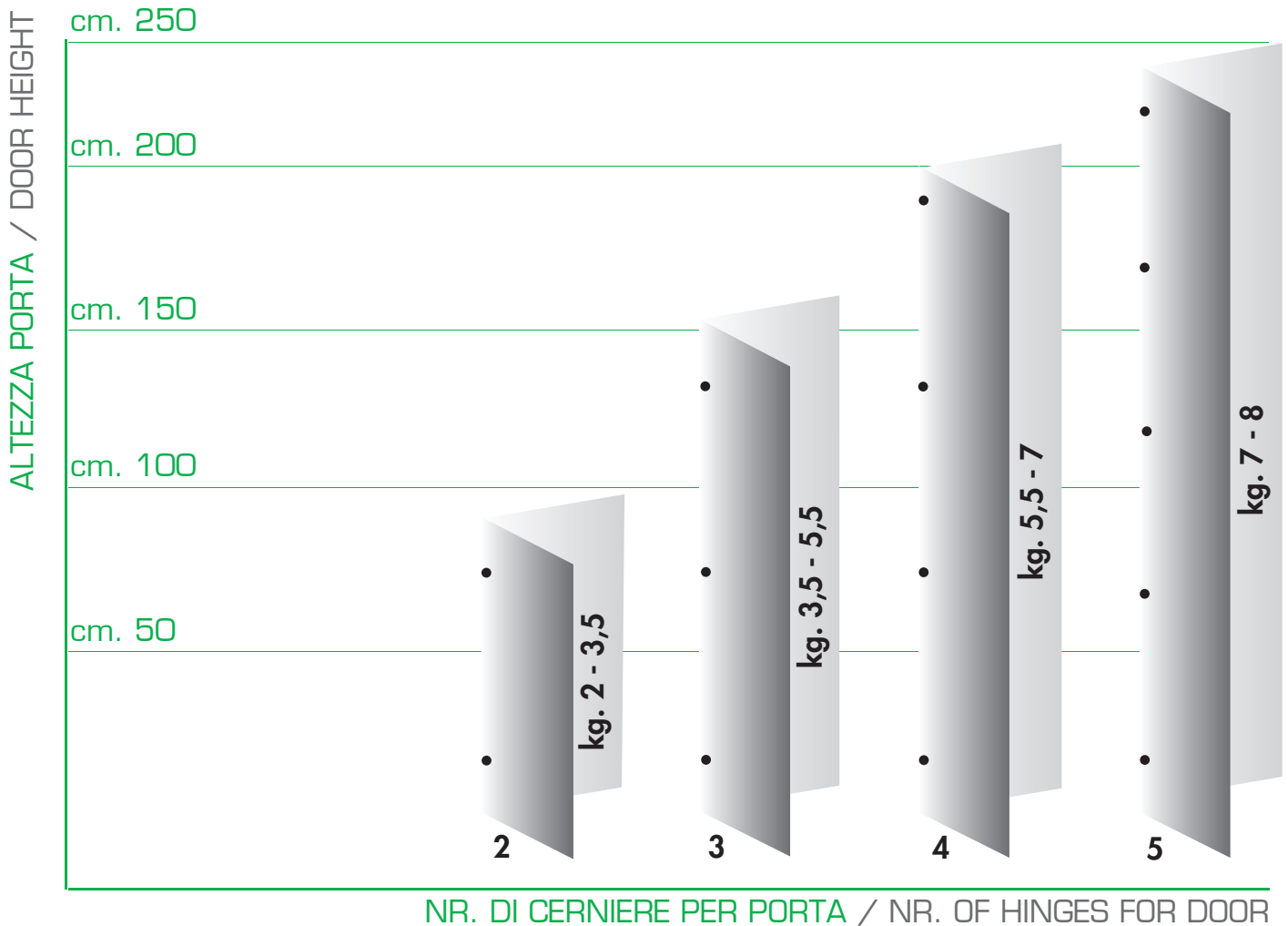

## IMBALLO PACKING

### CONTENUTO/CONTENTS

SERIE 640

CERNIERE/HINGES 500

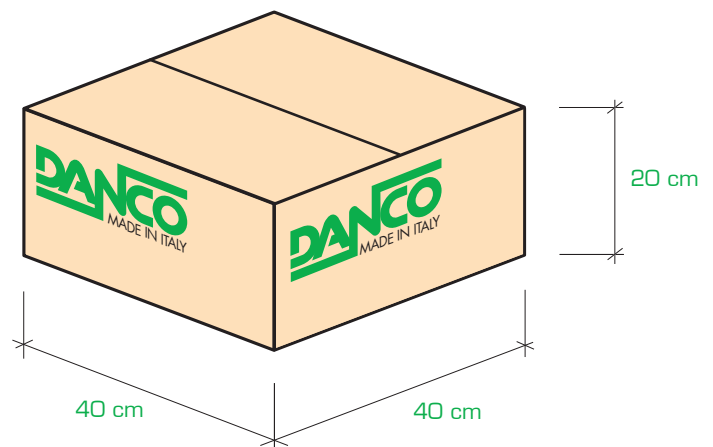



# CERNIERE HINGES



## CERNIERE A CHIUSURA AUTOMATICA APERTURA 94°

## SELF CLOSING HINGES OPENING 94°

640



P

4

4

Braccetto in acciaio, collo (P) Piano.  
Steel, crank (P) Straight.

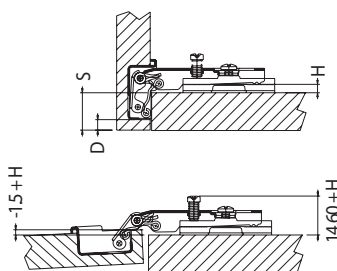
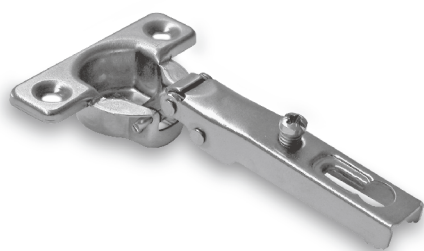

FORO ANTA (D)  
DISTANCE IN THE  
DOOR (D)

	3	4	5	6	7
4	16	17	18	19	20
5	15	16	17	18	19
6	14	15	16	17	18
7	13	14	15	16	17
8	12	13	14	15	16
9	11	12	13	14	15
10	10	11	12	13	14

SPESSORE BASETTA (H)  
THICKNESS OF MOUNTING PLATE (H)

**H = 17 + D - S**

640



M

4

4

Braccetto in acciaio, collo (M) Medio.  
Steel, crank (M) Medium.

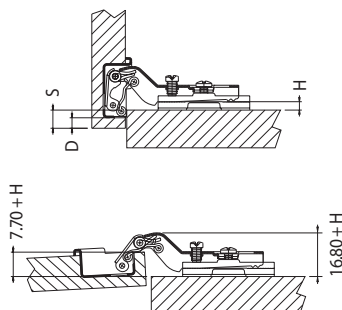

FORO ANTA (D)  
DISTANCE IN THE  
DOOR (D)

	3	4	5	6	7
4	6	7	8	9	10
5	5	6	7	8	9
6	4	5	6	7	8
7	3	4	5	6	7
8	2	3	4	5	6
9	1	2	3	4	5
10	0	1	2	3	4

SPESSORE BASETTA (H)  
THICKNESS OF MOUNTING PLATE (H)

**H = 7 + D - S**

640



C

4

4

Braccetto in acciaio, collo (C) Collo alto.  
Steel, crank (C) Tall.

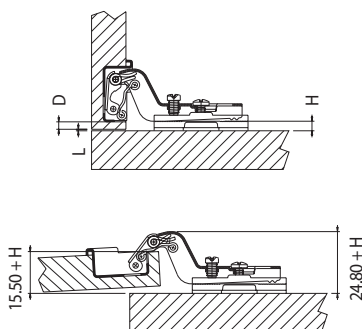

FORO ANTA (D)  
DISTANCE IN THE  
DOOR (D)

	3	4	5	6	7
4		1 LUCE	0	1	2
5			1 LUCE	0	1
6				1 LUCE	0
7					1 LUCE
8					
9					
10					

SPESSORE BASETTA (H)  
THICKNESS OF MOUNTING PLATE (H)

**H = -1 + D + L**



# CERNIERE A CHIUSURA AUTOMATICA APERTURA 94° PER CRISTALLO

## SELF CLOSING HINGES OPENING 94° GLASS DOOR

**640** **3F** **P** **1** **4** Braccetto in acciaio, collo (P) Piano.  
Steel, crank (P) Straight.

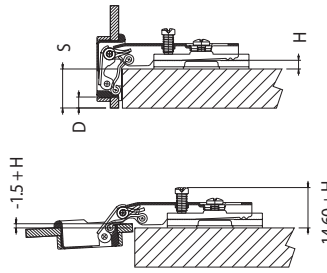
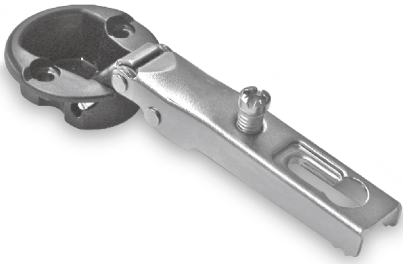

FORO ANTA (D)  
DISTANCE IN THE  
DOOR (D)

	3	4	5	6	7
4	16	17	18	19	20
5	15	16	17	18	19
6	14	15	16	17	18
7	13	14	15	16	17
8	12	13	14	15	16
9	11	12	13	14	15
10	10	11	12	13	14

SPESSORE BASETTE (H)  
THICKNESS OF MOUNTING PLATE (H)

**H = 17 + D - S**

**640** **3F** **M** **1** **4** Braccetto in acciaio, collo (M) Medio.  
Steel, crank (M) Medium.

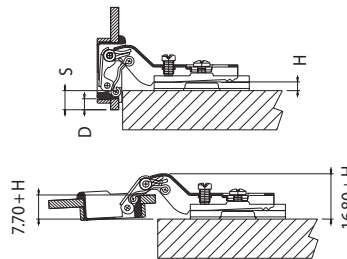
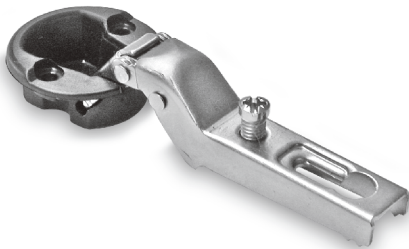

FORO ANTA (D)  
DISTANCE IN THE  
DOOR (D)

	3	4	5	6	7
4	6	7	8	9	10
5	5	6	7	8	9
6	4	5	6	7	8
7	3	4	5	6	7
8	2	3	4	5	6
9	1	2	3	4	5
10	0	1	2	3	4

SPESSORE BASETTE (H)  
THICKNESS OF MOUNTING PLATE (H)

**H = 7 + D - S**

**640** **3F** **C** **1** **4** Braccetto in acciaio, collo (C) Collo alto.  
Steel, crank (C) Tall.

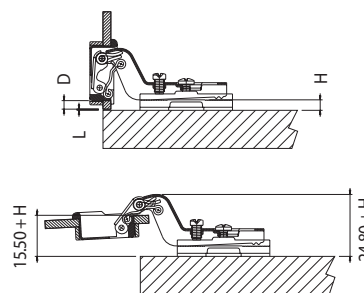
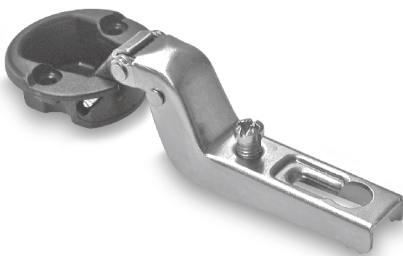

FORO ANTA (D)  
DISTANCE IN THE  
DOOR (D)

	3	4	5	6	7
4		1 LUCE	0	1	2
5			1 LUCE	0	1
6				1 LUCE	0
7					1 LUCE
8					
9					
10					

SPESSORE BASETTE (H)  
THICKNESS OF MOUNTING PLATE (H)

**H = -1 + D + L**

## CERNIERE A CHIUSURA AUTOMATICA APERTURA 94° PER ANGOLI 30°

## SELF CLOSING HINGES OPENING 94° FOR CORNERS 30°

645

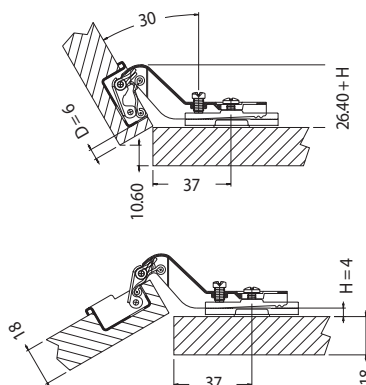
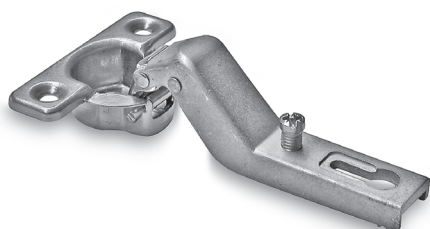
Braccetto in zama, collo (C) Collo alto.  
Zamak, crank (C) Tall.

## CERNIERE A CHIUSURA AUTOMATICA APERTURA 94° PER ANGOLI 45°

## SELF CLOSING HINGES OPENING 94° FOR CORNERS 45°

646

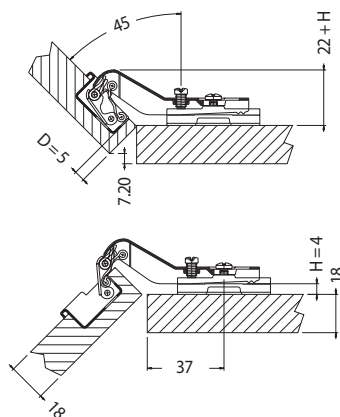
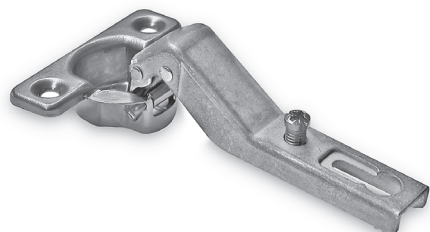
Braccetto in zama, collo (C) Collo alto.  
Zamak, crank (C) Tall.

## CERNIERE A CHIUSURA AUTOMATICA APERTURA 94° PER ANGOLI 90°

## SELF CLOSING HINGES OPENING 94° FOR CORNERS 90°

647

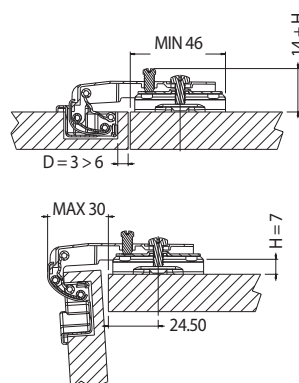
Braccetto in zama, collo (P) Piano.  
Zamak, crank (P) Straight.





645•646•647



CERNIERE A CHIUSURA AUTOMATICA APERTURA 94° PER ANGOLI 30° PER CRISTALLO

SELF CLOSING HINGES OPENING 94° FOR CORNERS 30° FOR GLASS DOORS

645

3F

C

1

4

Braccetto in zama, collo (C) Collo alto.  
Zamak, crank (C) Tall.

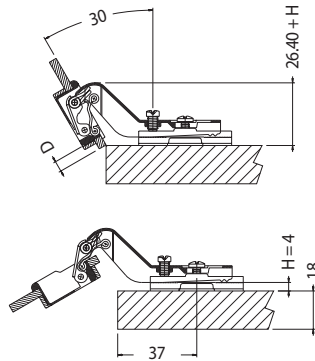
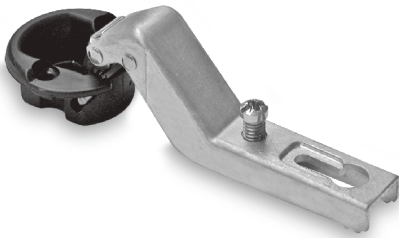

CERNIERE A CHIUSURA AUTOMATICA APERTURA 94° PER ANGOLI 45° PER CRISTALLO

SELF CLOSING HINGES OPENING 94° FOR CORNERS 45° FOR GLASS DOORS

646

3F

C

1

4

Braccetto in zama, collo (C) Collo alto.  
Zamak, crank (C) Tall.

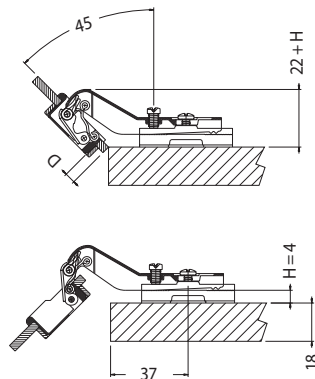
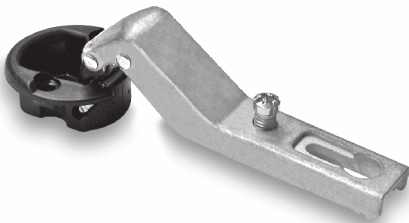

CERNIERE A CHIUSURA AUTOMATICA APERTURA 94° PER ANGOLI 90° PER CRISTALLO

SELF CLOSING HINGES OPENING 94° FOR CORNERS 90° FOR GLASS DOORS

647

3F

P

1

4

Braccetto in zama, collo (P) Piano.  
Zamak, crank (P) Straight.

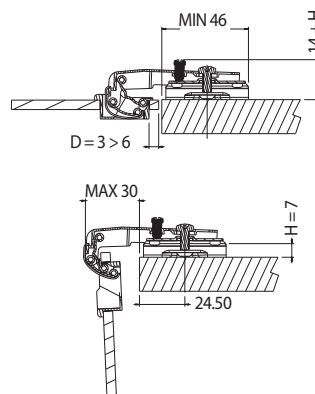

cerniere  
hinges

SPAZIO OCCORRENTE PER APRIRE UN'ANTA SENZA INTERFERIRE CON ALTRE ANTE

SPACE NEEDED TO OPEN A DOOR WITHOUT INTERFERING WITH THE OTHERS

**T** = SPESSORE ANTA / THICKNESS OF THE DOOR

**D** = DISTANZA FORO ANTA / DRILLING DISTANCE IN THE DOOR

**L** = LUCE FRA ANTA E FIANCO / DISTANCE BETWEEN THE DOOR AND THE SIDE

SERIE 640										
T	16	17	18	19	20	21	22	23	24	25
D 3	1,32	1,64	2,02	2,60	3,46	4,35	5,26	6,19	7,12	8,07
D 4	1,27	1,58	1,94	2,36	2,99	3,83	4,70	5,59	6,49	7,42
D 5	1,23	1,53	1,87	2,26	2,72	3,40	4,21	5,06	5,93	6,82
D 6	1,19	1,48	1,80	2,17	2,59	3,10	3,81	4,60	5,43	6,29
D 7	1,16	1,43	1,75	2,09	2,49	2,95	3,51	4,22	5,00	5,81

#### Note

Notes



640

# CASSE CUPS







640•645•646•647



# BASETTE MOUNTING PLATES

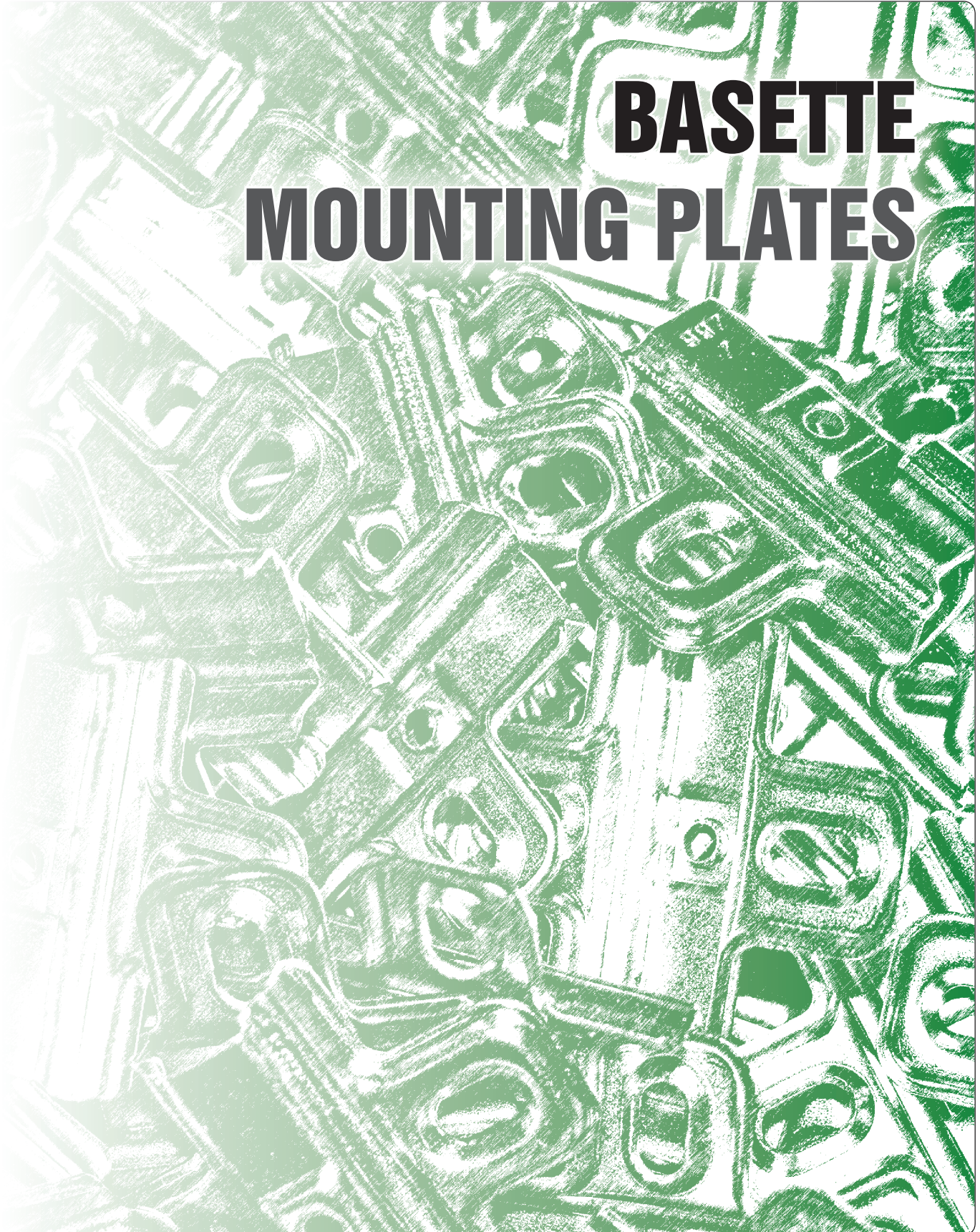

basette  
mounting plates

## BASETTE DISPONIBILI - REVERSIBILI

## AVAILABLE MOUNTING PLATES - REVERSIBLES

## B 893 AR V

SPESSORE THICKNESS  
mm. 3 - 5 - 6,5 - 8 - 10

Basetta in zama reversibile; Regolazione verticale interasse 32 mm., modulo 37.  
Zamak reversible mounting plate; Vertical setting wheelbase 32 mm., modulus 37.



reversibile

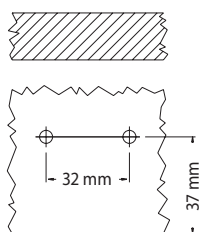

## B 893 ER V

SPESSORE THICKNESS  
mm. 3 - 5 - 6,5 - 8 - 10

Basetta in zama reversibile; Fissaggio a viti Euro (escluse dalla fornitura); Regolazione verticale interasse 32 mm., modulo 37.  
Zamak reversible mounting plate; Euro screws fastener (not included in supply); Vertical setting wheelbase 32 mm., modulus 37.

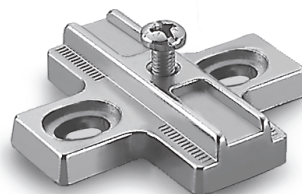

reversibile

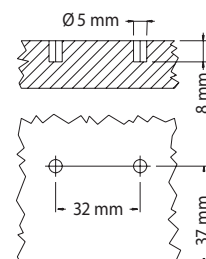

## B 893 ER L V

SPESSORE THICKNESS  
mm. 3 - 5 - 6,5 - 8 - 10

Basetta in zama reversibile; Fissaggio a viti Euro 6,3 x 14; Regolazione verticale interasse 32 mm., modulo 37.  
Zamak reversible mounting plate; Euro screws fastener 6,3 x 14; Vertical setting wheelbase 32 mm., modulus 37.

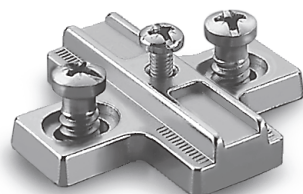

reversibile

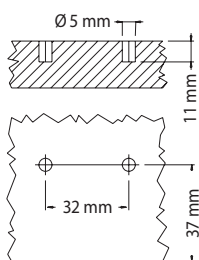

## B 893 ER C V

SPESSORE THICKNESS  
mm. 3 - 5 - 6,5 - 8 - 10

Basetta in zama reversibile; Fissaggio a viti Euro 6,3 x 10,5; Regolazione verticale interasse 32 mm., modulo 37.  
Zamak reversible mounting plate; Euro screws fastener 6,3 x 10,5; Vertical setting wheelbase 32 mm., modulus 37.

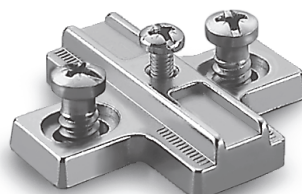

reversibile

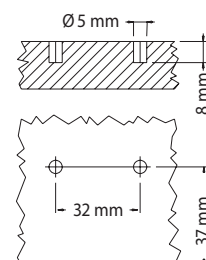

## B 893 P10 V

SPESSORE THICKNESS  
mm. 3 - 5 - 6,5 - 8 - 10

Basetta in zama reversibile; Fissaggio a pressione (bussole Ø 10 mm.); Regolazione verticale interasse 32 mm., modulo 37.  
Zamak reversible mounting plate; Pressurized fastener (Ø 10 mm. dowels); Vertical setting wheelbase 32 mm., modulus 37.

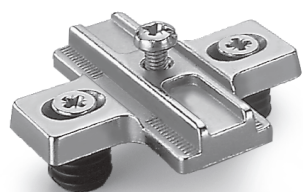

reversibile

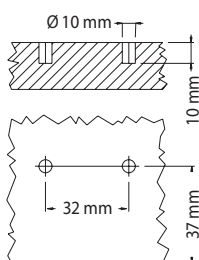

## B 988 AR V

SPESSORE THICKNESS  
mm. 3 - 5

Basetta in zama; Regolazione verticale mediante camma interasse 32 mm., modulo 37.  
Zamak mounting plate; Vertical setting by cam wheelbase 32 mm., modulus 37.

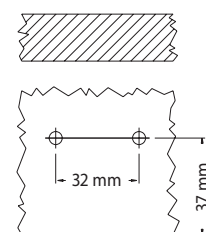

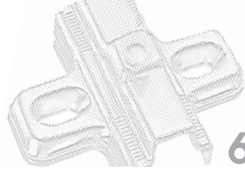

640•645•646•647

**BASETTE DISPONIBILI - REVERSIBILI****AVAILABLE MOUNTING PLATES - REVERSIBLES****B 997 AR V****SPESSORE THICKNESS**  
mm. 4 - 5 - 7

Basetta in acciaio reversibile; Regolazione verticale interasse 32 mm., modulo 37.  
Steel reversible mounting plate; Vertical setting wheelbase 32 mm., modulus 37.

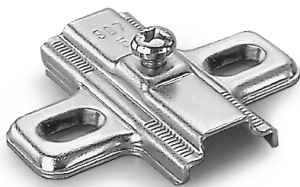

reversibile

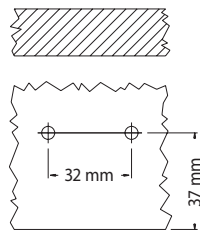
**B 997 ER V****SPESSORE THICKNESS**  
mm. 4 - 5 - 7

Basetta in acciaio reversibile; Fissaggio a viti Euro (escluse dalla fornitura); Regolazione verticale interasse 32 mm., modulo 37.  
Steel reversible mounting plate; Euro screws fastener (not included in supply); Vertical setting wheelbase 32 mm., modulus 37.

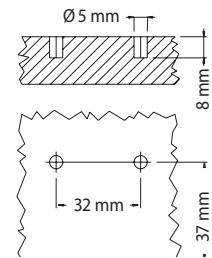

reversibile

**B 997 ER L V****SPESSORE THICKNESS**  
mm. 4 - 5 - 7

Basetta in acciaio reversibile; Fissaggio a viti Euro 6,3 x 14; Regolazione verticale interasse 32 mm., modulo 37.  
Steel reversible mounting plate; Euro screws fastener 6,3 x 14; Vertical setting wheelbase 32 mm., modulus 37.

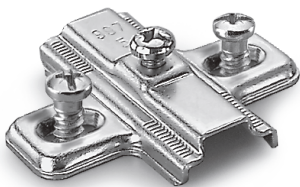

reversibile

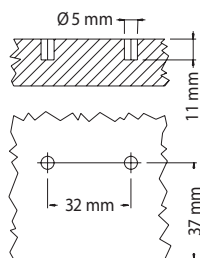
**B 997 ER C V****SPESSORE THICKNESS**  
mm. 4 - 5 - 7

Basetta in acciaio reversibile; Fissaggio a viti Euro 6,3 x 10,5; Regolazione verticale interasse 32 mm., modulo 37.  
Steel reversible mounting plate; Euro screws fastener 6,3 x 10,5; Vertical setting wheelbase 32 mm., modulus 37.

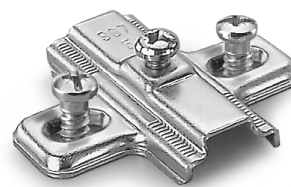

reversibile

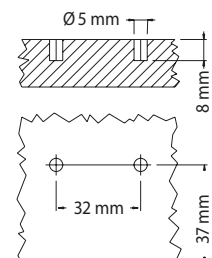
**B 997 P5 I V****SPESSORE THICKNESS**  
mm. 4 - 5 - 7

Basetta in acciaio reversibile; Fissaggio a bussole  $\varnothing$  5 mm. Regolazione verticale interasse 32 mm., modulo 37.  
Steel reversible mounting plate;  $\varnothing$  5 mm. dowels fastener; Vertical setting wheelbase 32 mm., modulus 37.

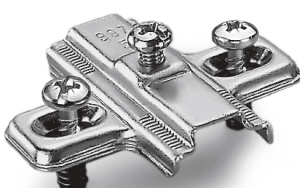

reversibile

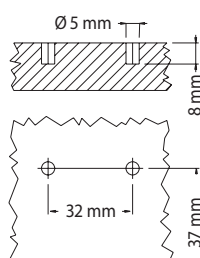
**B 997 P10 V****SPESSORE THICKNESS**  
mm. 4 - 5 - 7

Basetta in acciaio reversibile; Fissaggio a pressione (bussole  $\varnothing$  10 mm.); Regolazione verticale interasse 32 mm., modulo 37.  
Steel reversible mounting plate; Pressurized fastener ( $\varnothing$  10 mm. dowels); Vertical setting wheelbase 32 mm., modulus 37.

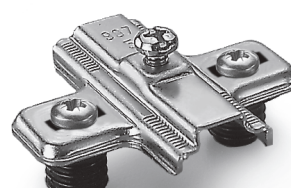

reversibile

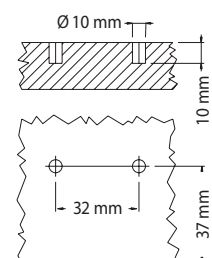
basette  
mounting plates

## BASETTE DISPONIBILI - REVERSIBILI

### AVAILABLE MOUNTING PLATES - REVERSIBLES

#### B 960 AR V

SPESSORE THICKNESS  
mm. 5

Basetta in acciaio.  
Steel mounting plate.

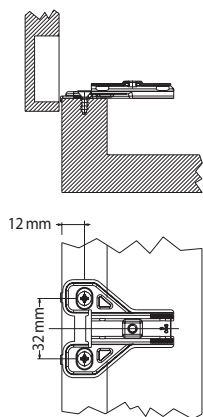

#### B 961 AR V

SPESSORE THICKNESS  
mm. 5

Basetta in acciaio.  
Steel mounting plate.

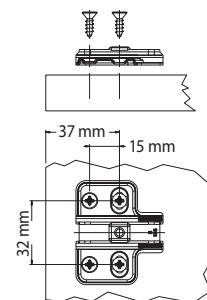





640 • 645 • 646 • 647



# ACCESSORI ACCESSORIES



accessori  
accessories

## PIASTRE IN PLASTICA PER CRISTALLO

### PLASTIC PLATES FOR GLASS DOOR HINGES

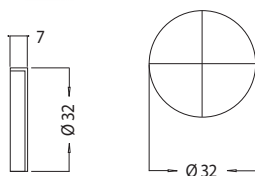
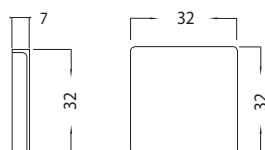
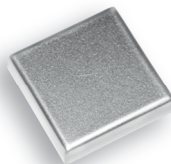
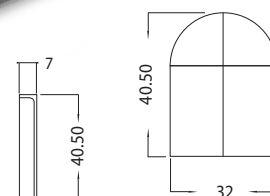
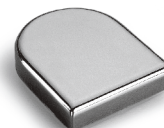
**Z 25**Piastra in nylon.  
Nylon plate.**Z 26**Piastra in nylon.  
Nylon plate.**Z 27**Piastra in nylon.  
Nylon plate.**FINITURE / FINISHING****N. RIF / REF:****N. RIF / REF:**

Nero / Black	<b>1</b>
Marrone / Brown	<b>2</b>
Bianco / White	<b>3</b>
Cromato / Chromium-plated	<b>5</b>
Cromato spruzzato / Chromium-lacquered	<b>5 SP</b>

Dorato / Gold-plated	<b>10</b>
Dorato spruzzato / Gold-lacquered	<b>10 SP</b>
Cromato opaco / Matt chromium-plated	<b>5 OP</b>
Cromato opaco spruzzato / Matt chromium-lacquered	<b>5 OP SP</b>
Dorato opaco / Matt gold-plated	<b>10 OP</b>
Dorato opaco spruzzato / Matt gold-lacquered	<b>10 OP SP</b>

## PIASTRE IN ALLUMINIO PER CRISTALLO

### ALUMINIUM PLATES FOR GLASS DOOR HINGES

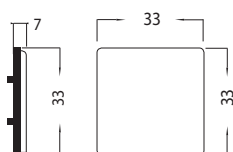
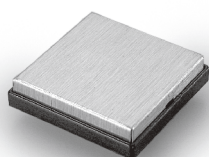
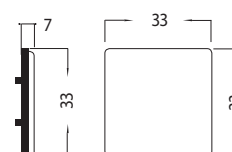
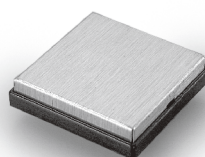
**Z 12**Piastra in alluminio; finitura: nichel satinato.  
Aluminium plate; finishing: brushed nickel.**Z 13**Piastra in alluminio; finitura: lucido.  
Aluminium plate; finishing: polished.



### T 008

Vite Euro  $\varnothing 6,3 \times 14$ .  
Euro screw  $\varnothing 6,3 \times 14$ .

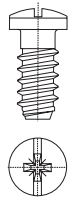

### T 009

Vite Euro  $\varnothing 6,3 \times 10,5$ .  
Euro screw  $\varnothing 6,3 \times 10,5$ .









Note  
Notes



Le immagini utilizzate in questo esempio d'ordine sono indicative e potrebbero non corrispondere a quelle del presente catalogo.



The images used in this example are indicative and may not correspond to those in this catalog.

	SERIE SERIE		SPESSORE Basetta IN MM MOUNTING PLATE THICKNESS IN MM
	CASSA CUP		ALTEZZA BRACCETTO CRANK HEIGHT
	BRACCETTO ARM		FINITURA CASSA CUP FINISHING
	BASSETTA MOUNTING PLATE		FINITURA BRACCETTO ARM FINISHING
	NUMERO RIFERIMENTO CASSA REFERENCE CUP NUMBER		FINITURA Basetta MOUNTING PLATE FINISHING

 altezza braccetto  
crank height

**P** = collo piano - straight crank      mm. 0  
**M** = collo medio - medium crank      mm. 8  
**C** = collo alto - tall crank              mm. 17

FINITURA  
FINISHING

NICHELATO - NIKEL PLATED              4  
 ZINCATO - GALVANIZED                  9

 VITE INSERITA  
INSERTED SCREW

 SENZA MOLLA  
WITHOUT SPRING

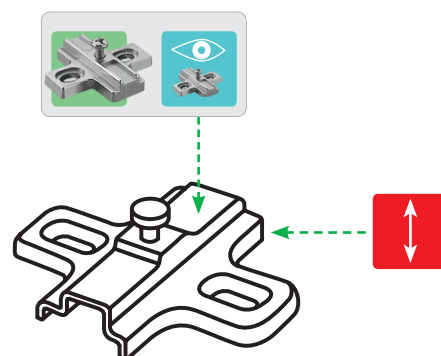
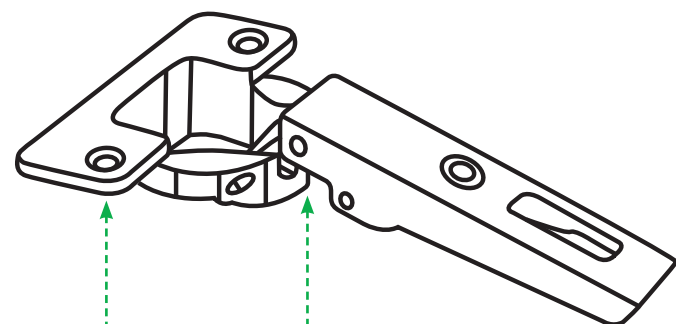

## ESEMPIO D'ORDINE

### EXAMPLE OF ORDER

Per una corretta ordinazione ed un'esatta determinazione del codice seguire le sottoindicate modalità, con la seguente successione:

For a proper order and an exact interpretation of the code, please follow the undermentioned indications in the following order:

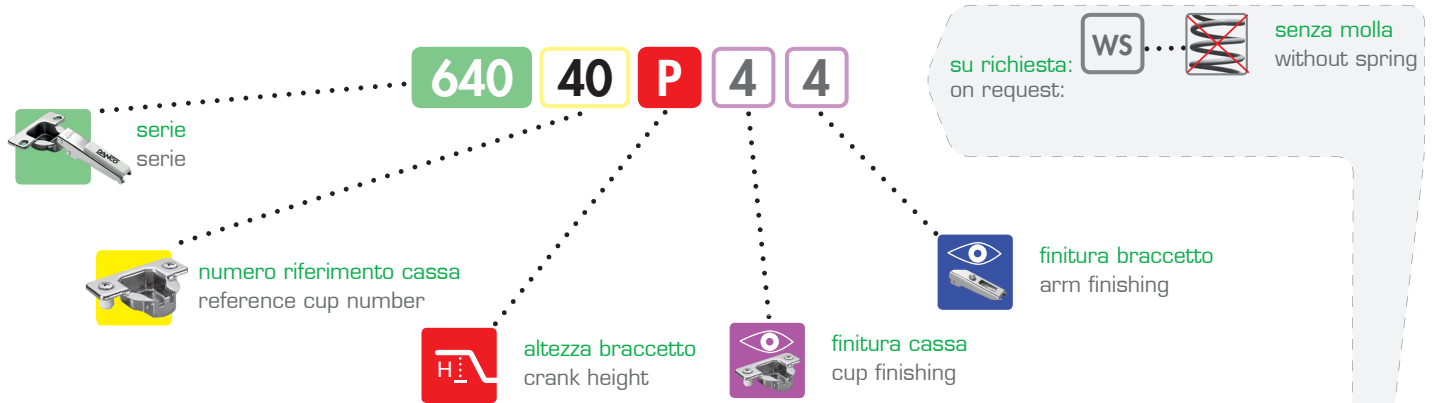

## ESEMPIO DI ORDINE CERNIERE - ORDERING EXAMPLE OF HINGES

	CODICE SERIE SERIE CODE	→	640
	NUMERO RIFERIMENTO CASSA REFERENCE CUP NUMBER	→	40
	ALTEZZA BRACCETTO CRANK HEIGHT	→	P
	FINITURA CASSA CUP FINISHING	→	4
	FINITURA BRACCETTO ARM FINISHING	→	4
	SENZA MOLLA WITHOUT SPRING	→	WS

Ordinare il seguente codice:  
Order the following code:

640 40 P 4 4

Si avrà quindi una cerniera con cassa e braccetto in acciaio nichelato, collo piano.  
You will therefore have a hinge with steel, nickel plated cup and arm, straight crank.

## ESEMPIO DI ORDINE BASETTE - ORDERING EXAMPLE OF MOUNTING PLATES

	CODICE BASETTA MOUNTING PLATE CODE	→	B 997 AR V
	SPESSORE THICKNESS	→	5
	FINITURA BASETTA MOUNTING PLATE FINISHING	→	4
	VITE INSERITA INSERTED SCREW	→	V

Ordinare il seguente codice:  
Order the following code:

B 997 AR V 5 4

Si avrà quindi una basetta cod. B 997 AR V con spessore 5 mm., nichelato.  
You will therefore have a mounting plate code B 997 AR V mm. 5 thickness, nickel plated.

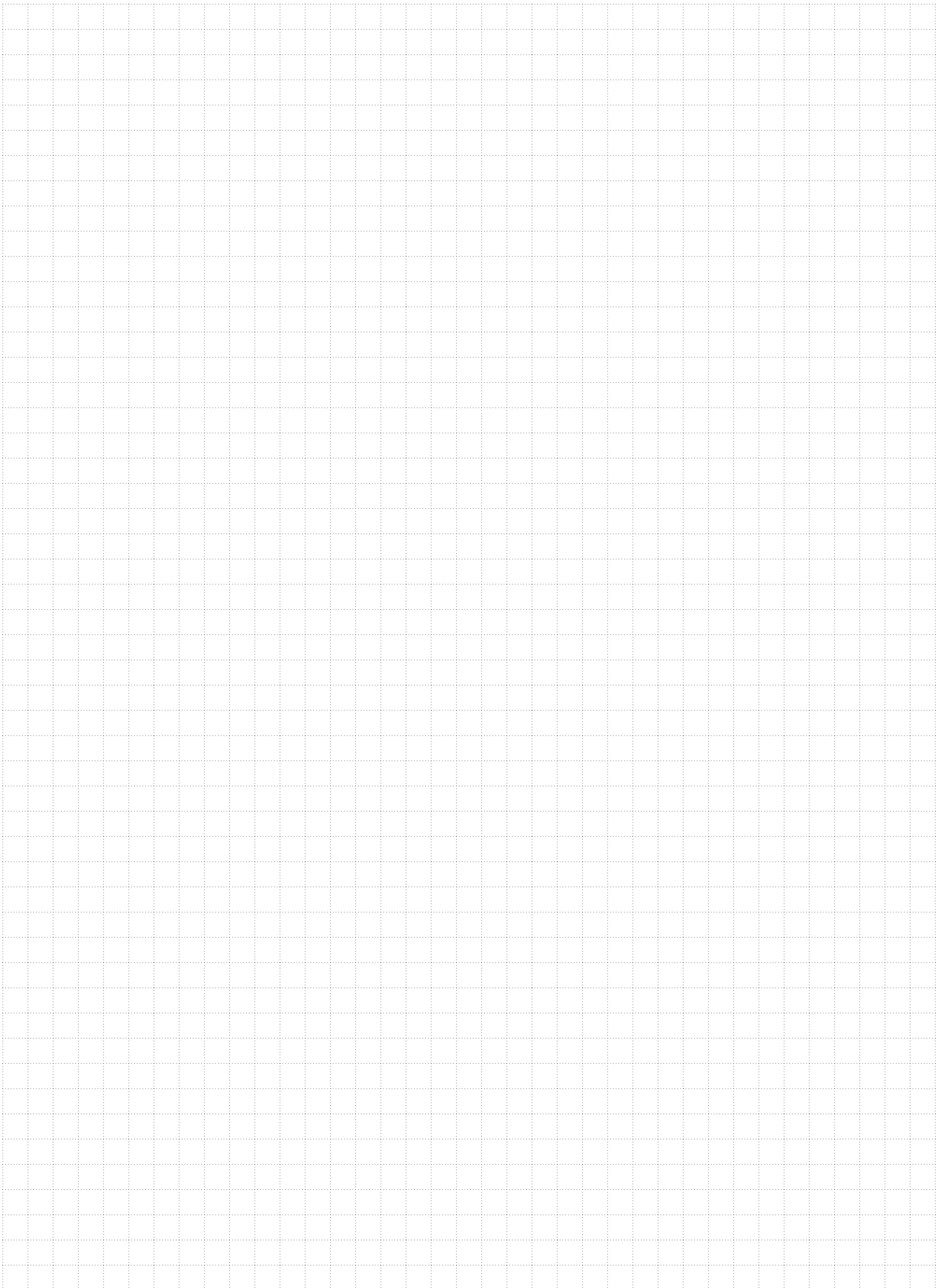

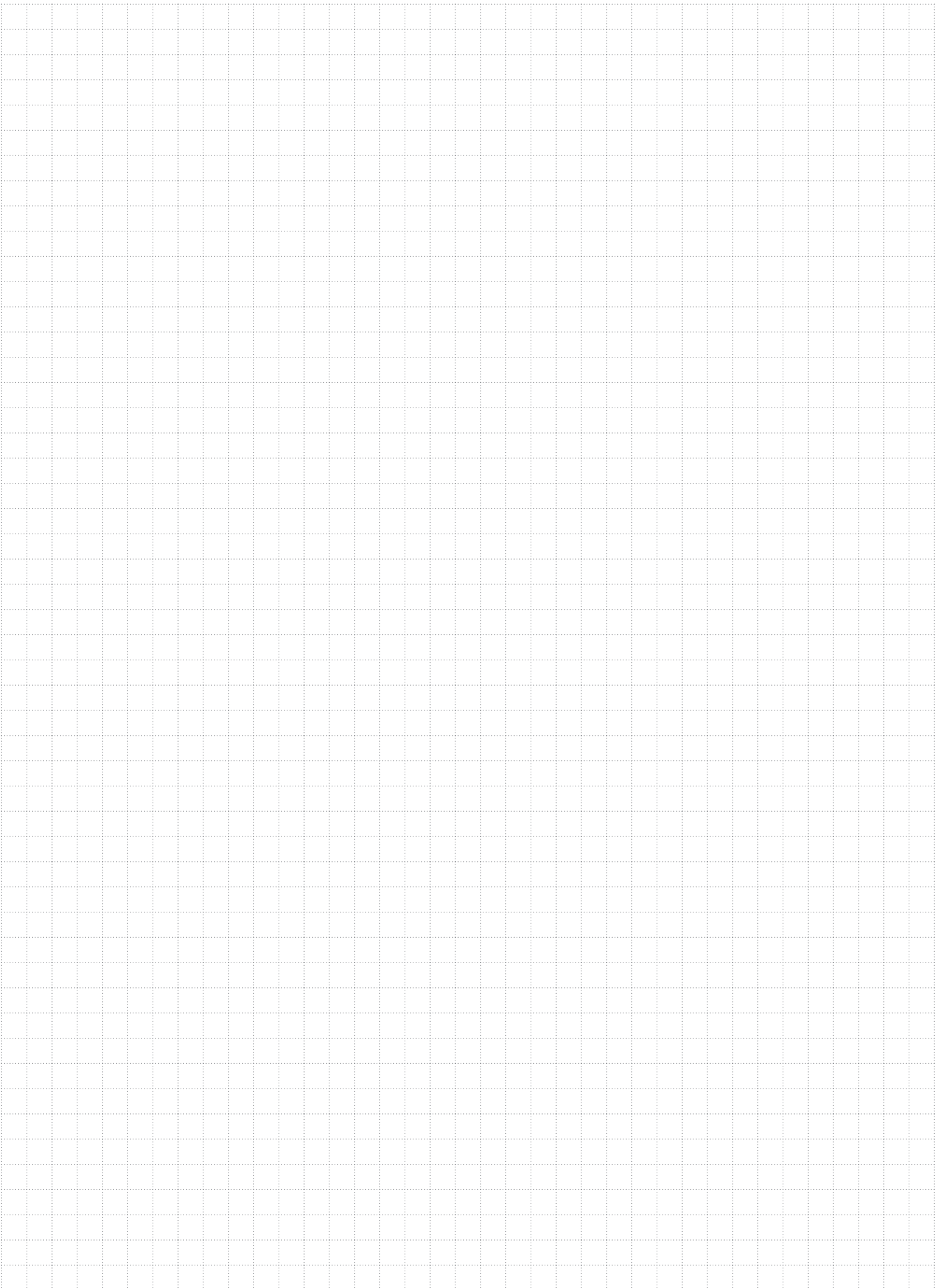

DANCO spa  
20837 VEDUGGIO (MB) - via Volta, 12  
Tel. +39 - 0362 998752 r.a.  
Fax +39 - 0362 998730  
danco@danco.it